

MESA 01

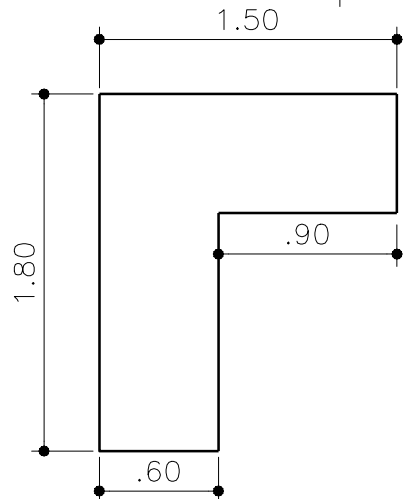

PLANTA BAIXA
1:25

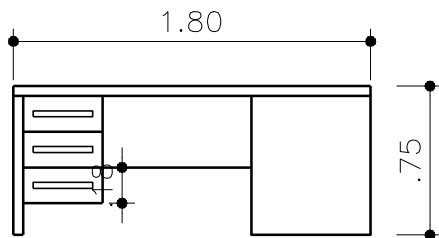

VISTA LATERAL
1:25

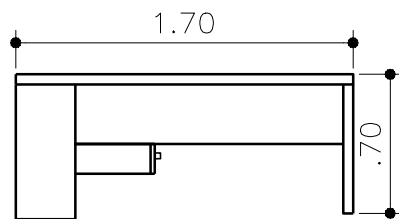

VISTA FRONTAL
1:25

MESA 02

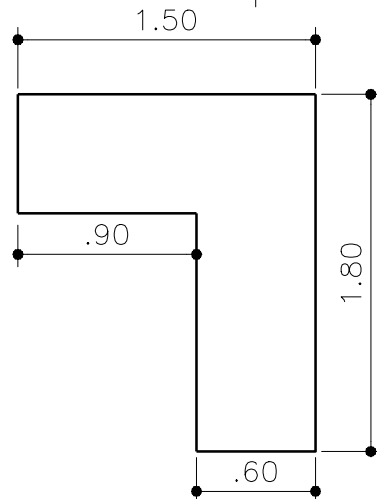

PLANTA BAIXA
1:25

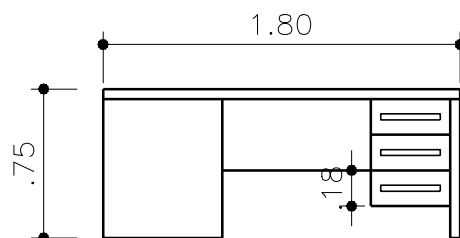

VISTA LATERAL
1:25

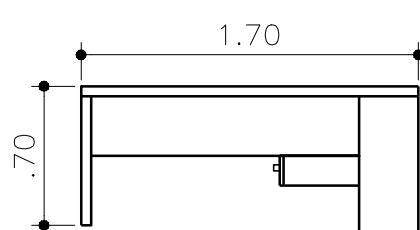

VISTA FRONTAL
1:25

NICHO 01 E 02

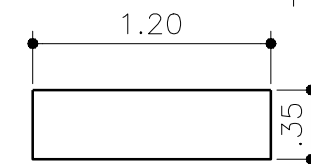

PLANTA BAIXA
1:25

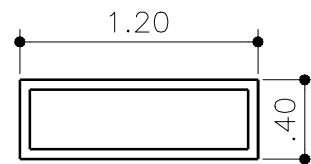

VISTA FRONTAL
1:25

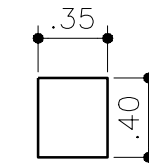

VISTA LATERAL
1:25

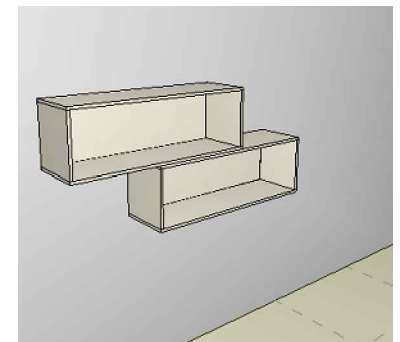

DIREITOS AUTORAIS RESERVADOS. LEI 9.610 DE 19.02.98.



PREFEITURA MUNICIPAL DE SARANDI

Palácio Municipal Dr. Mário Azambuja
PRAÇA GETÚLIO VARGAS S/N-SARANDI-RS

projeto: **MOBILIA SECRETARIA ESCOLA MILTON ALVEZ DE SOUZA**

data:
ABR/2015

Proprietário:
PREFEITURA MUNICIPAL DE SARANDI
Paulo Rodolfo Viccari Kasper - Prefeito Municipal

Responsável Técnico:
RENATA CRISTINA CASTOLDI
Arquiteta e Urbanista
CAU/RS A70045-2

esc:
INDICADA

projeto: **MESA 01 E 02; NICHOS 01 E 02 - SECRETARIA**

pranchas:
02